



FOR SUBLEASE - 11,567 SF

# Lincoln Commerce Park II

2115 South 11th Avenue, Suite 120, Phoenix, Arizona



## AVAILABLE SPACE:

Suite 120, ±11,567 rentable square feet

## FEATURES:

- Brand new office build-out
- Plug & play space including phone system, furniture, warehouse racking, pallet jack
- Office area - 3,314 square feet
- 1 Grade Level & 2 Truckwell Loading Docks
- 24' Clear Height
- Freeway Frontage with full diamond interchange at 7th Avenue & I-17 Freeway
- Bay Depth - 231'
- 200 Amps, 277- 480 Volts, 3-Phase power
- A-2 Zoning, City of Phoenix
- Sublease through October 31, 2013
- Asking \$0.40/sf/mo NNN

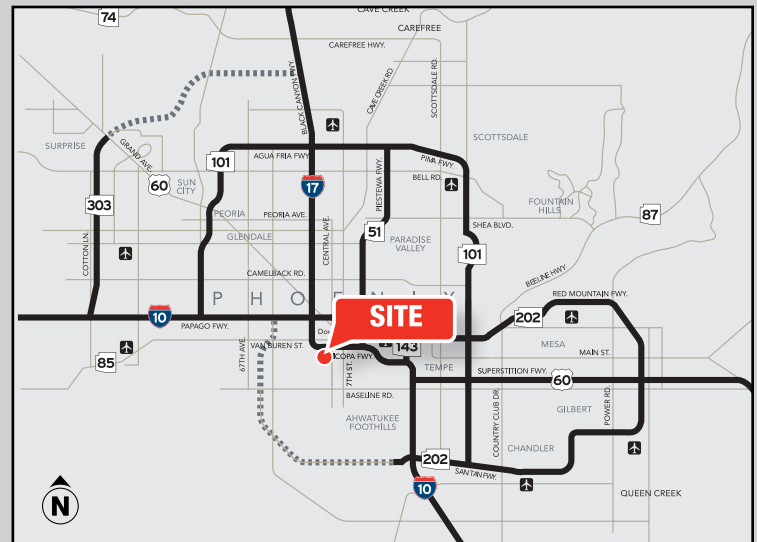

For more information, please contact:

**Jackie Orcutt**  
 Associate  
 602.229.5960  
 jackie.orcutt@cushwake.com

**Mark Detmer SIOR, CCIM**  
 Executive Director  
 602.229.5971  
 mark.detmer@cushwake.com

© Copyright 2011 - Cushman & Wakefield Inc. - All rights reserved. No warranty or representation, express or implied, is made as to the accuracy of the information contained herein, and same is submitted subject to errors omissions, change of price, rental or other conditions, withdrawal without notice, and to any specific listing conditions, imposed by our principals.



FOR SUBLEASE - 11,567 SF

# Lincoln Commerce Park II

2115 South 11th Avenue, Suite 120, Phoenix, Arizona

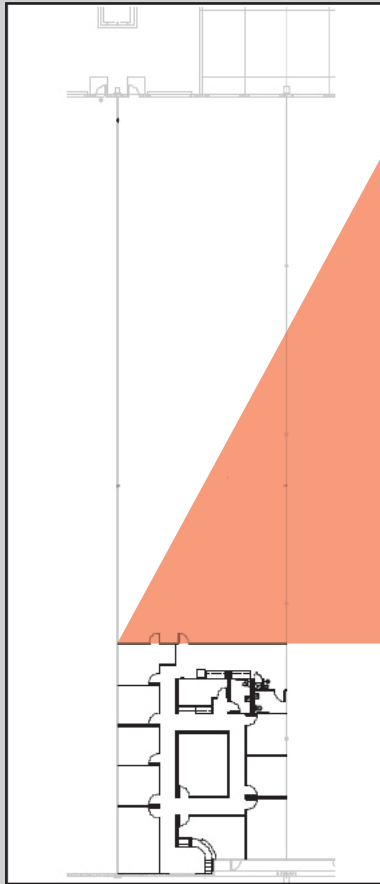

## OFFICE LAYOUT

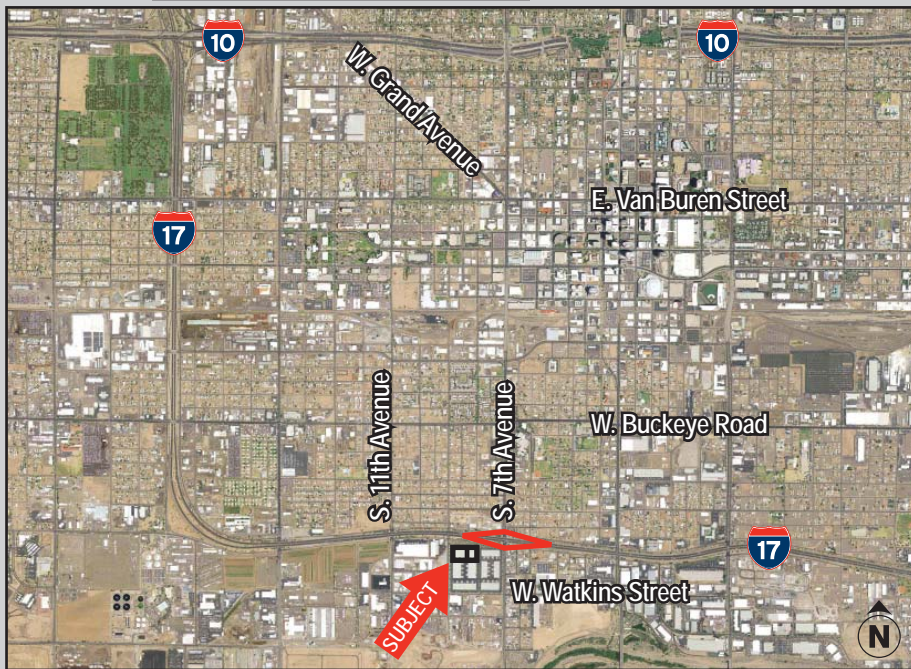
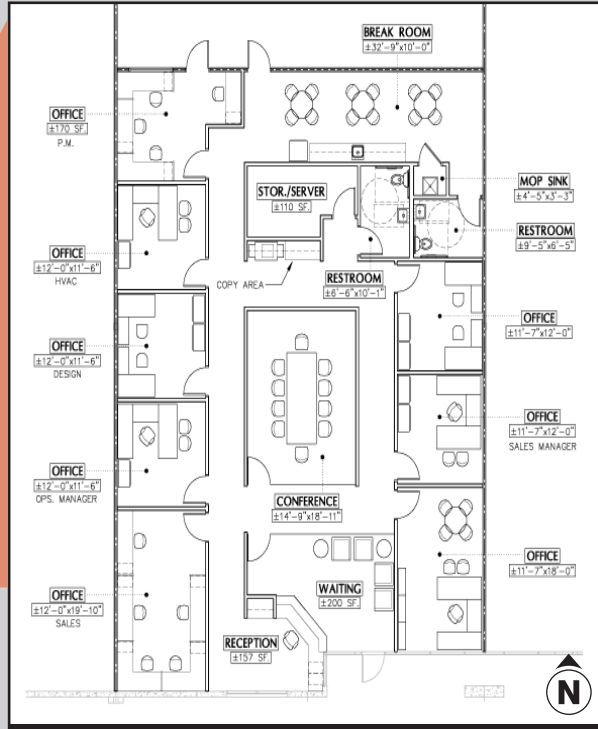

For more information, please contact:

**Jackie Orcutt**

Associate  
602.229.5960  
jackie.orcutt@cushwake.com

**Mark Detmer SIOR, CCIM**

Executive Director  
602.229.5971  
mark.detmer@cushwake.com

© Copyright 2011 - Cushman & Wakefield Inc. - All rights reserved. No warranty or representation, express or implied, is made as to the accuracy of the information contained herein, and same is submitted subject to errors omissions, change of price, rental or other conditions, withdrawal without notice, and to any specific listing conditions, imposed by our principals.

2555 East Camelback Road  
Suite 300  
Phoenix, Arizona 85016

Telephone: (602) 253-7900  
Fax: (602) 253-0528

