



Exclusively represented by



Owned & Managed by



WAREHOUSE SPACE AVAILABLE FOR LEASE

685 WEST LA VIEVE LANE

TEMPE, ARIZONA
WARNER ROAD & I-10 FREEWAY



BUILDING SIZE	±101,641 sf
OFFICE	8,519 sf first floor office 2,405 sf warehouse office
SITE	6.7 acres
LOADING	Eight (8) grade level doors & Eighteen (18) truck level cross dock
CLEAR HEIGHT	24'
ZONING	I-2, City of Tempe
POWER	2,000 amps; 277/480v



WAREHOUSE SPACE AVAILABLE FOR LEASE

Exclusively represented by



Owned & Managed by



For more information, please contact:

JACKIE ORCUTT

(602) 229.5960

jackie.orcutt@cushwake.com

STEVE SAYRE

(602) 229.5928

steve.sayre@cushwake.com

MARK DETMER SIOR, CCIM

(602) 229.5971

mark.detmer@cushwake.com

685 WEST LA VIEVE LANE

TEMPE, ARIZONA
WARNER ROAD & I-10 FREEWAY

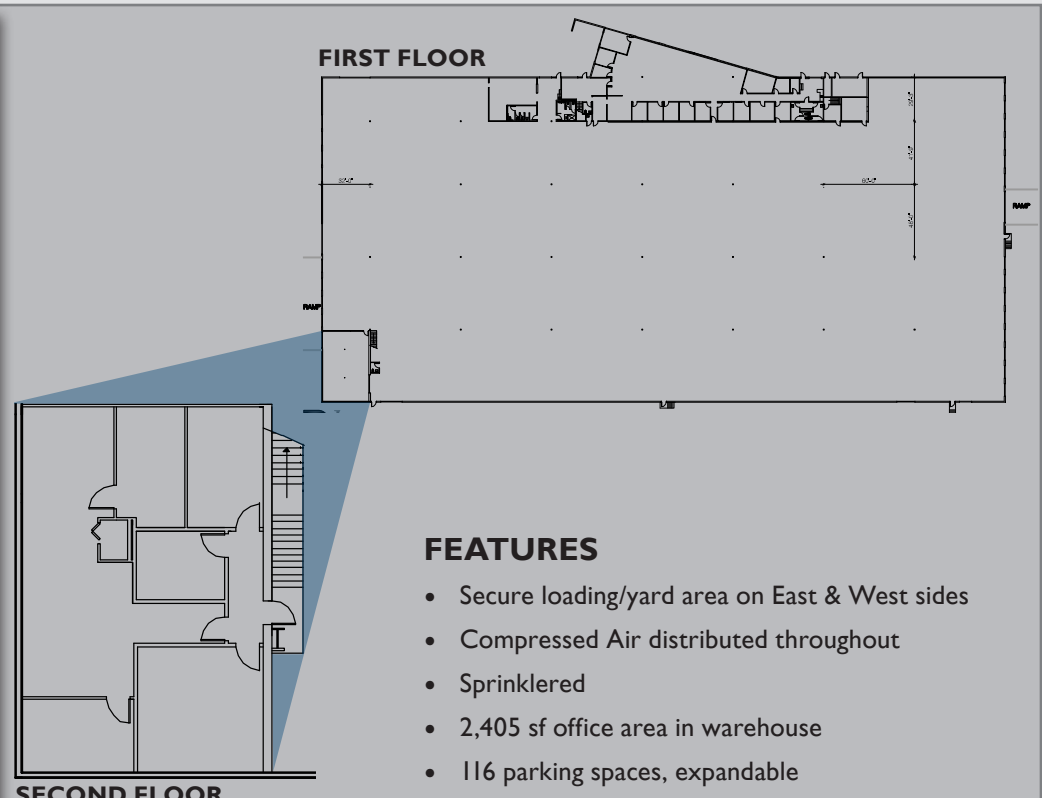
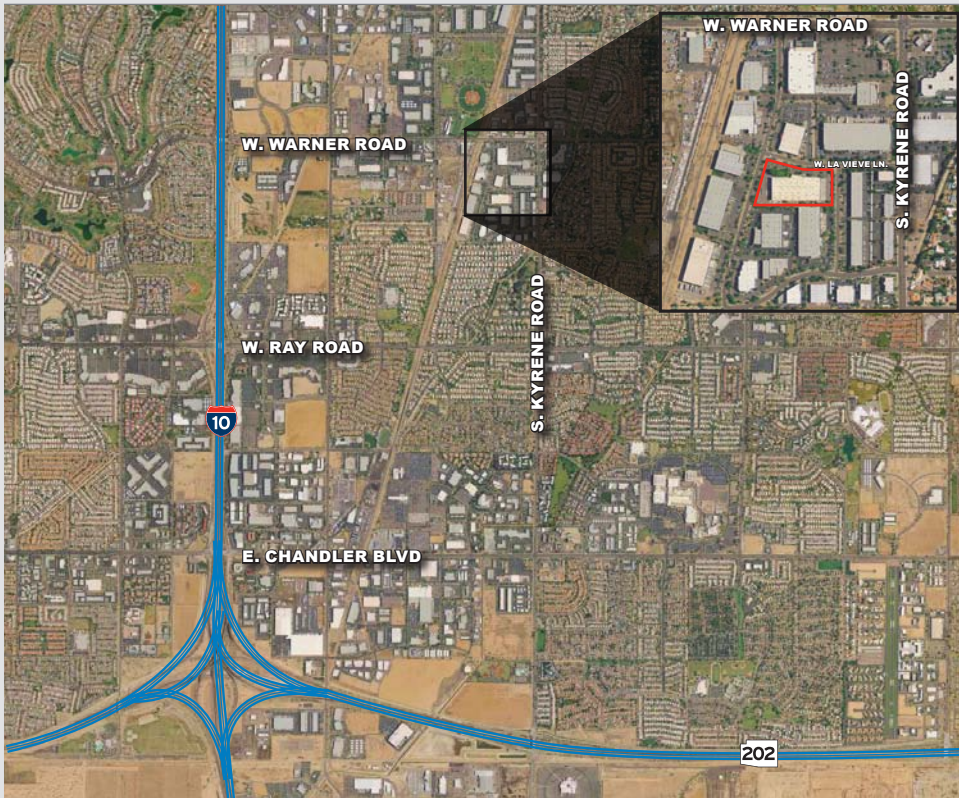

FEATURES

- Secure loading/yard area on East & West sides
- Compressed Air distributed throughout
- Sprinklered
- 2,405 sf office area in warehouse
- 116 parking spaces, expandable
- Double wide grade level doors

The depiction in the above photograph of any person, entry, sign, logo or property (other than Cushman & Wakefield's client and the property offered by Cushman & Wakefield) is incidental only, and is not intended to connote any affiliation, connection, association, sponsorship or approval by or between that which is incidentally depicted and Cushman & Wakefield or its client.

This listing shall not be deemed an offer to lease, sublease or sell such property; and, in the event of any transaction for such property, no commission shall be earned by or payable to any cooperating broker except if otherwise provided pursuant to the express terms, rates and conditions of C&W's agreement with its principal, if, as and when such commission (if any) is actually received from such principal. (A copy of the rates and conditions referred to above with respect to this property is available upon request.)