

>> 156,120 SF AVAILABLE FOR LEASE

Goodyear Point - Building 1

2950 South Litchfield Road, Goodyear Arizona



BUILDING SIZE:	± 418,200 sf
AVAILABLE:	± 156,120 sf
OFFICE:	±1,600 sf
CLEAR HEIGHT:	32'
LOADING:	Dock and grade level (34 dock doors, 2 grade level)
ZONING:	I-1, City of Goodyear

FEATURES:

- Divisible
- Cross dock
- On-site trailer storage
- ESFR sprinklers
- T-5 lights
- 52' x 50' column spacing
- 60' speedbay
- R.13 insulation
- Floors sealed and caulked
- Interior walls and columns painted
- Skylights

LOCATION:

- Lower Buckeye Road and Litchfield Road frontage
- 2.5 miles south of I-10
- Adjacent to future I-10 reliever
- Within Goodyear's new "Employment Corridor"

for more information, please contact:

Bo Mills, SIOR CCIM
Executive Director
602.229.5970
bo.mills@cushwake.com

Will Strong
Senior Associate
602.229.5909
will.strong@cushwake.com

2555 East Camelback Road
Suite 300
Phoenix, Arizona 85016



>> 156,120 SF AVAILABLE FOR LEASE

Goodyear Point - Building 1

2950 South Litchfield Road, Goodyear Arizona

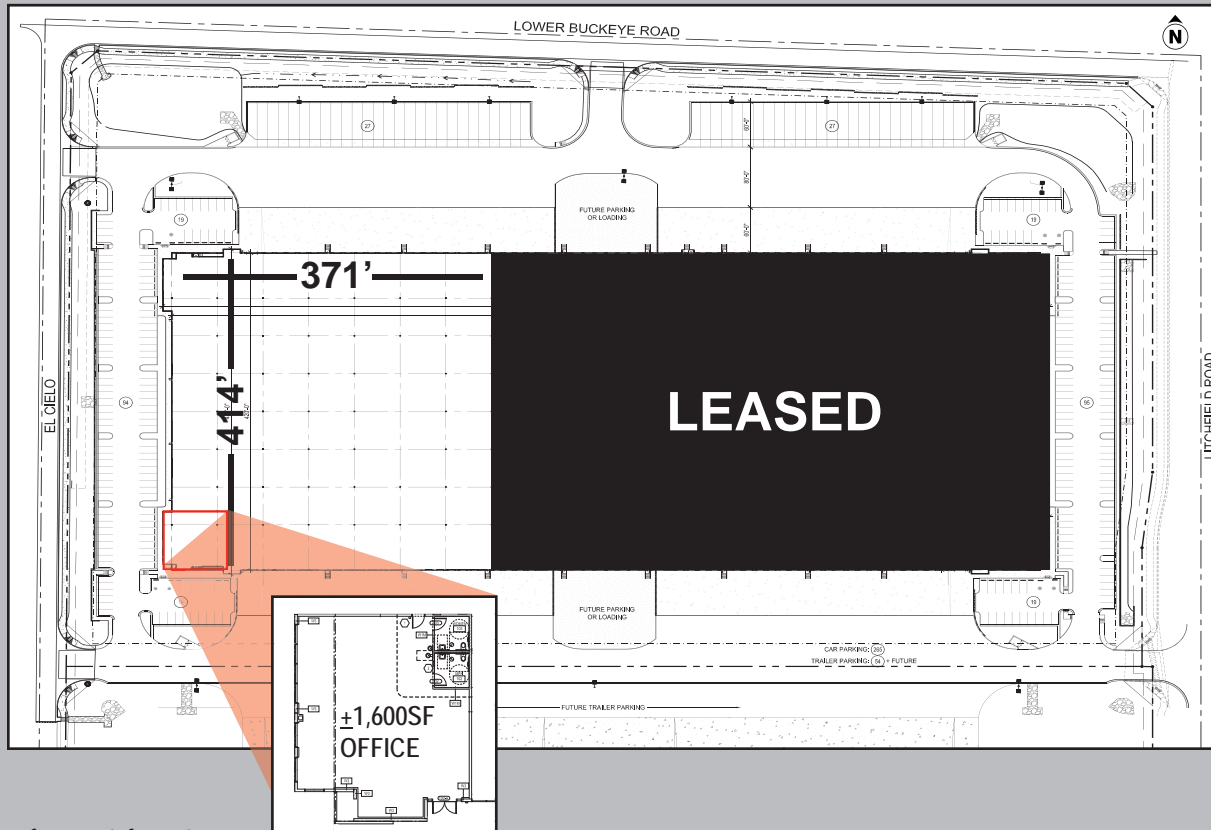

for more information,
please contact:

Bo Mills, SIOR CCIM
Executive Director
602.229.5970
bo.mills@cushwake.com

Will Strong
Senior Associate
602.229.5909
will.strong@cushwake.com

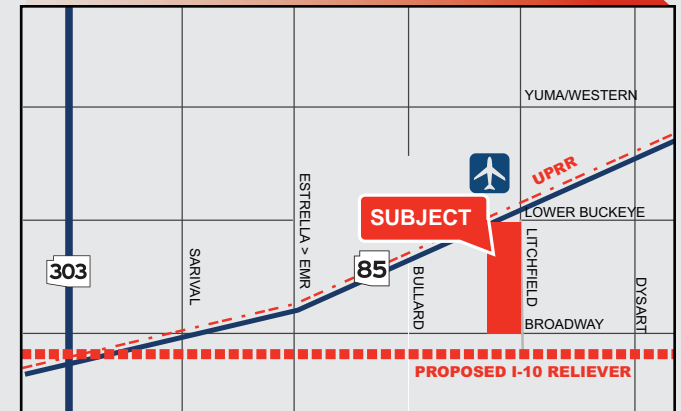

© Copyright 2012 - Cushman & Wakefield Inc. - All rights reserved. No warranty or representation, express or implied, is made as to the accuracy of the information contained herein, and same is submitted subject to errors omissions, change of price, rental or other conditions, withdrawal without notice, and to any specific listing conditions, imposed by our principals.